

Building Evacuation Plan

Baypine Road

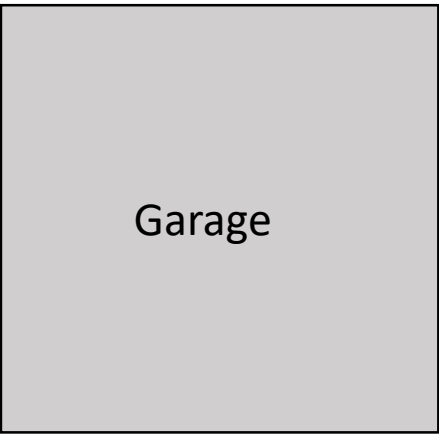

Garage

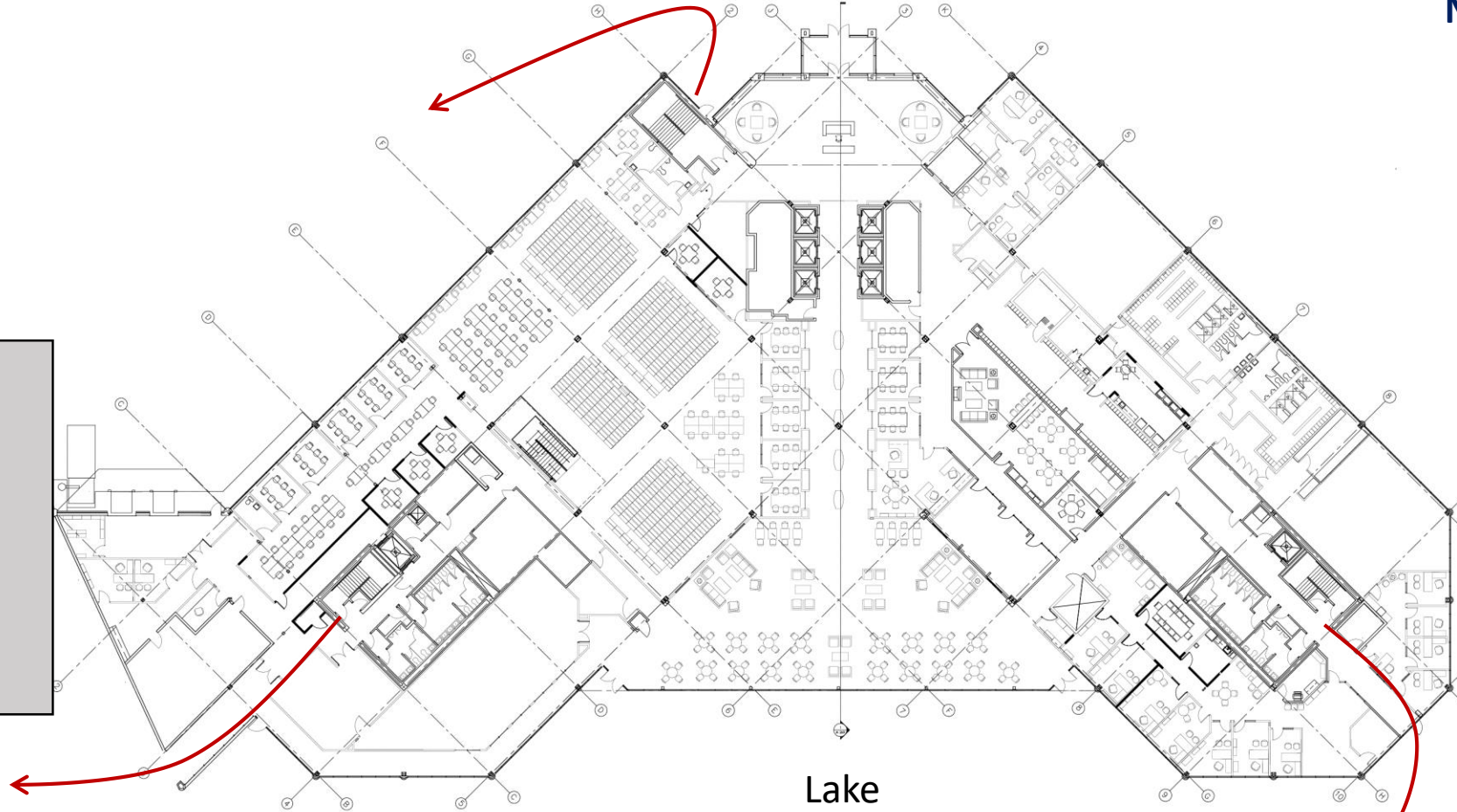

Lake

Collection Point

@ Gazebo at corner of the garage



Coastal Law Evacuation Procedure

Everyone in the building must evacuate upon alarm.

Building Evacuation Procedure

- Quickly gather only necessary personal belongings such as purses, phones and car keys
- Leave the building immediately in a calm, orderly manner through the closest stairwell and available exit
- Do **NOT** use elevators
- If there is no one behind you, close doors as you leave
- Listen for and follow instructions
- Stay together in a group with your class or work section if possible. Instructors must account for all students. Supervisors must account for all employees in their work sections.
- Do not attempt to leave campus
- Move and remain at least 150 feet away from the building
- WAIT for the ALL CLEAR from Security. Do not return to the building or move to another side of the building unless told to do so by emergency personnel.