

Baypine Building Evacuation Plan



Baypine Road

East Collection Point

@ East end of parking lot
near parking garage

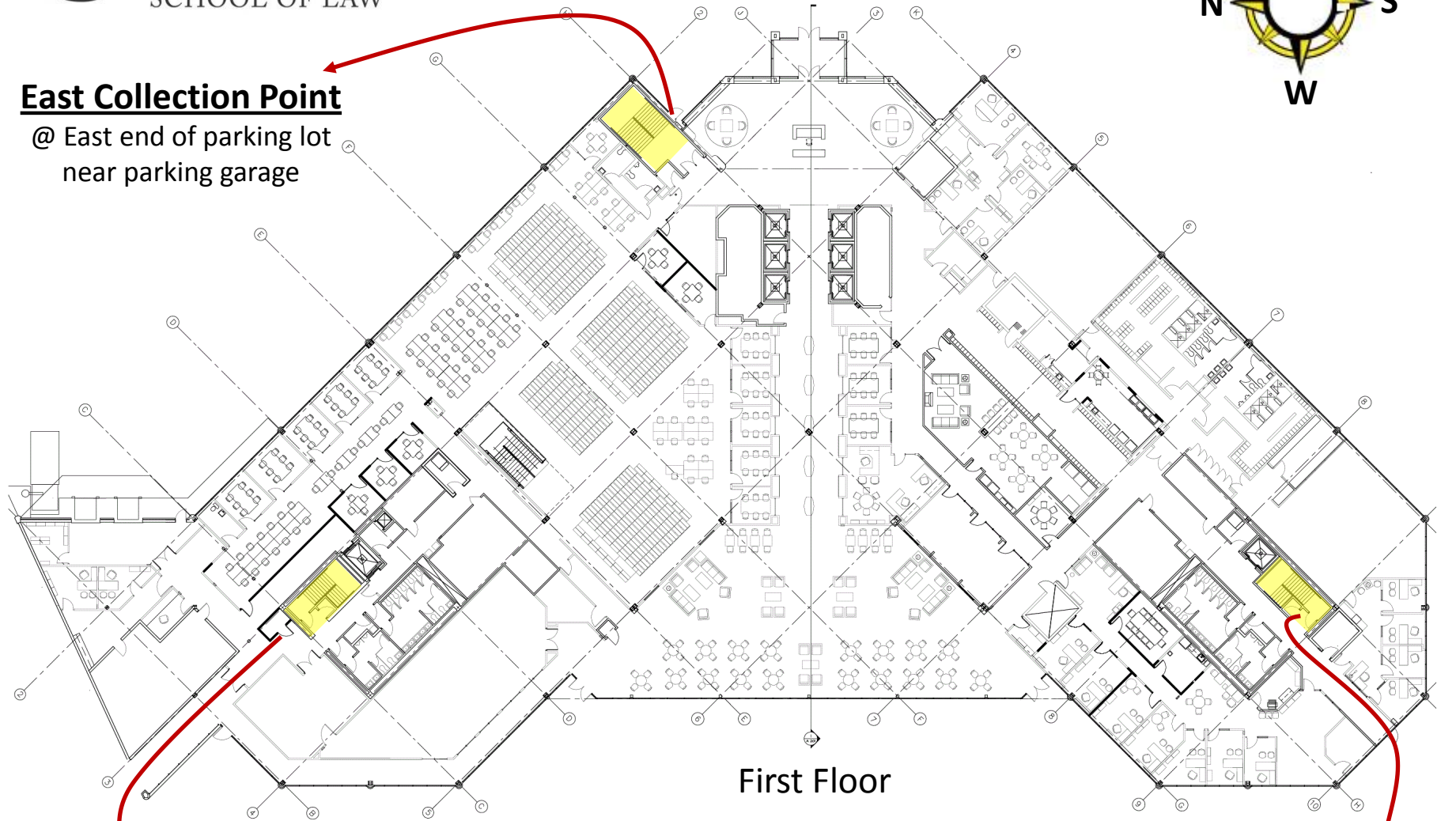

First Floor

Lake

North Collection Point

@ Gazebo next to FDIC Building

South Collection Point

@ Gazebo next to Art Institute

FCSL Fire Drill/Evacuation Procedure

Everyone in the building must evacuate upon hearing the alarm.

Building Evacuation Procedure

- Terminate class or study activity.
- Move to closest stairwell or exit.
- Do not use elevators.
- Exit in an orderly and efficient manner.
- Walk to collection point designated for each exit.
- Wait for ALL CLEAR from Security to return to building.

NOTE:

- People with disabilities or injuries will be assisted from building by Security.
- People with disabilities or injuries should remain inside the closest stairwell to meet Security.*
- Security will “sweep” each floor and assist those needing help in exiting.
- Do not attempt to go up stairs to exit. In library, use emergency exit doors on each floor.
- Do not pack up belongings; evacuate immediately.
- Do not go to car or attempt to leave.
- Do not congregate in parking garage.
- Security will release people from each collection point when ALL CLEAR is given.

* Baypine Building only